



Essential Guidebook

For International Students at BJTU

International Center
School of Economics and Management
Beijing Jiaotong University



Summary

About Beijing Jiaotong University.....	1
Application.....	2
Admission	4
Visa.....	4
Arrival.....	4
Accommodation	8
Money Matters	10
Catering	11
Transportation	12
Communications.....	15
Facilities.....	16
Student association	19
Other information	20
Sightseeing in Beijing	21

About Beijing Jiaotong University

Introduction

Beijing Jiaotong University (BJTU), located at Xizhimenwai of Beijing, is a national key university of China, directly under the administration of the Ministry of Education. Her predecessor is Beijing Railway Management Training Institute and Beijing School of Posts and Telecommunications, set up by Ministry of Posts and Telecommunications of Qing Dynasty. In 1921, the school merged with two industrial technical schools in Shanghai and Tangshan form the National Jiaotong University, with three branch universities in Beijing, Shanghai and Tangshan respectively. BJTU was then called as Beijing Campus of National Jiaotong University.

After the founding of the People's Republic of China in October 1st 1949, BJTU was re-named as Northern Jiaotong University (NJTU) by the State Council. Chairman Mao Zedong appointed Academician Mao Yisheng, a nationally renowned expert in bridge engineering, as the first president of NJTU. In 1951, Chairman Mao Zedong autographed the name of the university. 1981, BJTU became one of the first key universities authorized by the central government to confer master's and doctoral degrees, and subsequently to confer titles of associate professors, professors and Ph.D. advisors. In July 1994, BJTU was selected as one of the first universities in the National 211 Project. In April 2000, Beijing Electrical Power College was merged into NJTU. Then the university was transferred from the Ministry of Railways to the Ministry of Education. In September 2003, the university restored the name Beijing Jiaotong University.

Address

3# Shangyuancun, Haidian District, Beijing

Arrive at Xizhimen transportation hub, find the Gaoliangqiao street, and go along this road, across the first t-shaped crossing and pass a small traffic light, turn to the right at the next corner before the next traffic light, you will get to our university.

In the map below, some names of major streets are translated, hoping it can help you to find our university easily.



Application

If you are interested in studying at BJTU as exchange student for one semester, please advise your exchange coordinator of your home university. Exchange coordinator of home university is asked to email the nomination list including the following information to Ms. Anya Gu (lingu@bjtu.edu.cn):

Name, Gender, Major, Year of Study, Email address

After the exchange coordinator has made nominations by email, exchange applicants shall apply online* at:

<http://study.bjtu.edu.cn/member/login.do>

Before they do the online application, please make sure they prepared for the documents as below:

- 1). **Enrollment certification** to prove the student is studying under a degree program at home university (major, duration);
- 2). **academic transcript**;
- 3). **electronic id photo**;
- 4). **photocopy of passport**.

The candidates may need to scan the documents above and upload them during the online application.

After the online application is submitted, exchange coordinator is asked to email the electronic copy of documents above to Ms. Anya Gu at lingu@bjtu.edu.cn.

*Students need to create an account to complete the online application with their own email address.

Nomination Deadlines:

For fall semester: May 15 and May 30 for application submission

For spring semester: November 15 and November 30 for application submission

Course Selection

We offer about 20 business courses taught in entirely in English for each semester.

Subject fields include:

Fall Semester		
Course Title	Credits	Hours
Organizational Behaviour	3	48
Managerial Economics	3	48
Accounting	3	48
Marketing	3	48
Data Models and Decisions	3	48
Advanced Management & Management Innovation	2	32
Organizational Behaviour and Leadership	3	45
Marketing Concepts and Commercialization	3	45
Entrepreneurship and New Venture Creation	3	45
Risk control and Management	3	45
Legal and Accounting Issues for New Ventures	3	45
Contemporary Chinese Society	2	32
Basic Chinese	4	64
Senior Operational Research (1)	2	32
Senior Operational Research (2)	2	32
Procurement and Supply Management	2	32
Logistic and Supply Chain Management	2	32
Spring Semester		
Course Title	Credits	Hours
Corporate Finance	3	48
Strategic Management	3	48
Operations Management	3	48
Human Resource Management	3	48
Corporate Social Responsibility	1	48
Legal and Accounting Issues for New Ventures	3	45
Financing New Ventures	3	45
Applied Venture Creation	3	45
Logistics and Supply Chain Management	2	32
Production and Operation Management	3	48
Logistics System Analysis and Design	2	32
International Logistics Operation	2	32

Logistics Cost Control	2	32
Warehouse Management and Stock Control	2	32
Transportation and Distribution Management	2	32

Note: The course offerings are subject to adjustment each semester. For course descriptions and other enquiries regarding the course offerings, exchange coordinators shall contact Anya Gu at lingu@bjtu.edu.cn

Admission

Once the application is submitted via the Online Application for International Students, Center for International Education will start the review process of the application and the admission documents will be mailed to the exchange coordinator of the home university.

Visa and Insurance

1. Before entering China, international students who are admitted by Beijing Jiaotong University shall apply for X1 visa or X2 visa with the admission notice and JW201/202 you received.

2. After entering China, international students shall register at BJTU as soon as possible and go to the police station within 24 hours for temporary accommodation registration in China (hotel excluded). International students shall apply for residence permit in BJTU within 30 days. All the fees incurred due to the delay shall be paid by the students.

Fees for Foreigner Physical Examination: Maximum 450 RMB.

Fees for residence permit: 500 RMB/year.

3. According to the requirements of the Ministry of Education of China, foreign students who will study in China for more than 6 months must purchase authorized insurance in China. Students can purchase insurance at the registration desk on registration day. For students who refuse to buy the required insurance, they can't register at Beijing Jiaotong University.

Insurance premium: 400 RMB/semester, 800 RMB/year.

(For more information, please refer to <http://www.lxbx.net/lxbx-eng.html>)

Arrival

BJTU offers free airport pick-up service on registration day stipulated on admission notice during the working hours.

Please send an email to lingu@bjtu.edu.cn to get an Arrival Information Form.

The airport pick-up fee is 500 RMB if students arrive on the other working days.

International students who cannot register at Beijing Jiaotong University on time

must inform the host university coordinator to get permission.

When you arrive at Beijing International Airport, we advise you to reach campus by subway or taxi.

Option One: Subway. Please take airport express and transfer to Subway Line Two at Dongzhimen Station (25 RMB), and get off at Xizhimen Station (4 RMB). If you have lots of luggage, you can take a taxi at Xizhimen Station to the South Gate of Beijing Jiaotong University directly (about 13 RMB).

Option Two: Taxi. Please take a taxi to the South Gate of Beijing Jiaotong University, it will cost about 120-140 RMB, and you can ask for a receipt from the driver.

Center for International Education (CIE) is the office in charge of international student affairs including application and admission, registration, accommodation on campus allocation etc. When you first come to BJTU, you need to visit CIE for registration. The CIE office is located in Level 1 Block C at BJTU Main Campus.

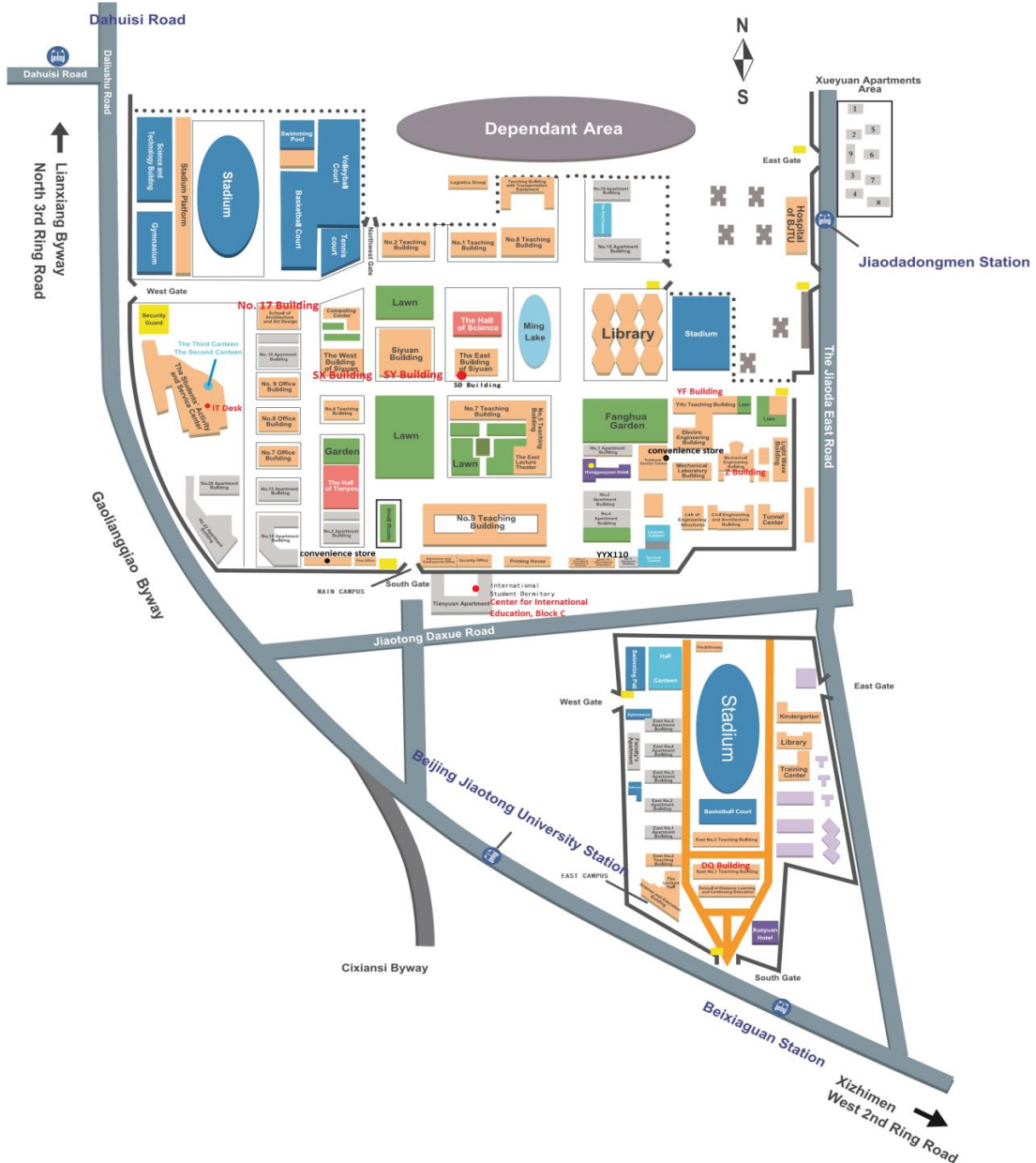

Below is the South Gate of BJTU Main Campus:



Below is the South Gate of BJTU East Campus:



You will be assigned with a Student Buddy from School of Economics and Management the day you arrive. The Student Buddy will meet and greet at the South Gate and will help you with registration at Center for International Education and will help you get familiarized with the campus. Throughout the semester you may ask for

advice from your Student Buddy if you have any questions regarding living on campus or touring around the city, your Student Buddy will be happy to help.

Accommodation

Type	Less than 90 days per bed/per day	More than 90 days		Room facilities
		Language student / advanced student 140 days (yuan/day.bed)	Professional student/ preparatory 180 days (yuan/day.bed)	
NO.14 Building (Twin Room)	50	5600	7200	Public facilities: bathroom, kitchen, lavatory and laundry room. Indoor: television, telephone, air-condition, Internet interface, single bed, bookcase desk, chair, wardrobe, TV cabinet
NO.1 Building (Twin Room)	60	6720	8640	Public facilities: kitchen, lavatory and laundry room. Indoor: independent bathroom , television, telephone, air-condition, Internet interface, single bed, bookcase desk, chair, wardrobe.
C#1 Block C1 (Twin Room)	65	7700	9900	Public facilities: kitchen and laundry room.Simple decoration Indoor: independent bathroom , brief outfit, television, telephone, air-condition, Internet interface, single bed, bookcase desk, chair, wardrobe,

C#2 Block C2 (Twin Room)	80	8400	10800	Public facilities: kitchen and laundry room.Fine decoration Indoor: independent bathroom , refined decoration, television, telephone, air-condition, Internet interface, single bed, bookcase desk, chair, wardrobe.
NO.4 Building (Twin Room)	60	6720	8640	Public facilities: kitchen, lavatory and laundry room. Indoor: independent bathroom , television, telephone, air-condition, Internet interface, single bed, bookcase desk, chair, wardrobe.

Note: International students can enjoy preferential policies after paying long-term accommodation.

Every new check-in student shall get a set of bedding (including a quilt, a mat, a pillow, two pieces of bedding bag, two sheets, two pillow-cases); If accommodation is paid on time, everyone shall be provided 30 degree of electricity; students in 1#,14#,C# shall be offered 8 yuan of hot water subsidies, and students pay on their own beyond this part.

Specific information is based on the actual situation when getting to school.

Money Matters

The currency used in China is the RMB. You can convert RMB in your home currency.

Banks

BJTU is the university nearest to the center of Beijing. There are many banks around the campus including:

- (1) ICBC Jiadadonglu Branch, address: No.9 Building, 18# Jiadadonglu, Haidian District(opposite to East Gate of BJTU);
- (2) ICBC Changhewan Branch, address: No.2 Building, 59# Gaoliangqiaoxiejie, Haidian District;
- (3) Bank of Communications Xizhimen Branch, address: No.2 Building, 59# Gaoliangqiaoxiejie, Haidian District;
- (4) BOC Bank of China Xizhimen Branch, address: Gaoliangqiaoxiejie, Haidian District;
- (4) CCB Daliushu Branch, address: No. 3-2, 1# Jiaotongdaxuelu, Haidian District;
- (5) CEB Xueyuanlu Branch, address: 56# Xizhimengbeidajie, Haidian District;
- (6) Bank of China Gaoliangqiao Branch, address: No.1 Building, 41# Jiadadonglu, Haidian District;
- (7) Huaxia Bank Xizhimen Branch, address: A tower, 60# Xizhimenbeidajie, Haidian District;
- (8) CITIC Bank Jinyundasha Branch, address: No.1 Building, 46# Xizhimenbeidajie jia, Haidian District;

Opening account

In China to open an account, you must carry passports, temporary residence permits, valid ID card to fill out the account application on the bank counter, and then you can apply for bank cards after the application is successful.

The most convenient bank for international exchange students to get an account with is ICBC and BOC. You can do it at ICBC Jiadadonglu Branch. If you are applying for a CSC scholarship, you need to get a Bank of China account. You need to contact Center for International Education regarding opening Bank of China account.

Cash withdrawal

You can withdraw cash by going to a counter of a bank in which you have a bank account, or by using a cash dispenser (ATM) if you have a withdrawal card. ATMs are everywhere on campus and open 24 / 7.

International foreign banker's cards are accepted by many ATMs, but they may charge transaction fee for every withdrawal. Ask for information to your bank about the cost of such transactions (commission, exchange rate).

Catering

Eat on campus

The canteens including a Muslim canteen in the newly built Student Recreation Center (学生活动中心) can accommodate 3,000 people simultaneously. Other canteens are located throughout the campus (No.1, No.2 No.3 and No.4 canteens). The canteens cater over 100 kinds of dishes every day. The average price for each meal in the canteen is about 10-15 RMB.

To eat on campus, you use your student ID card. You can recharge with cash at service kiosks everyday during lunch or dinner time. If you have Bank of China account you may recharge it directly at Kiosk at Level 1 Student Recreation Center (学生活动中心).

Canteens open time:

Breakfast 7:00am-9:00am

Lunch 11:00am-2:00pm

Dinner 5:00pm-8:00pm

Tips:

1. You can go to the dining hall a bit early or late if you don't want to feel too crowded. Of course, the varieties of food and dishes will not be so abundant than that the peak hour.

2. After having meals, please bring the dinner set to the place of collection which is generally at the entrance/exit of the dining hall.



Eat off campus

There are so many different restaurants with special local flavor of Chinese cuisines around BJTU. You can always find your favorite restaurant in Beijing.

Here is a list of some Chinese restaurants nearby:

Judian Grill: South side of Jiaotong University Road, Haidian District (200 meters east from south gate of BJTU)

La Shang Yin Restaurant (Sichuan cuisine): 8 Jiaotong University Road, Haidian District (200 meters east from south gate of BJTU)

Ali Restaurant (Xinjiang Muslim cuisine): 54 Jiaoda East Road, Haidian District

Zhongjun Laobian Dumpling Restaurant: South side of Jiaotong University Road, Haidian District (200 meters east from south gate of BJTU)

There are so many different cuisines around campus, you can have a taste of almost all Chinese local favors.

.....

You can also find some Western food:

Subway: Opposite to the south gate of BJTU

Burger King: Across the street from the south gate of BJTU

McDonald's: 2 Daliushu Road, Haidian District (400 meters north from east gate of BJTU)

Pizza Hut: Second floor of Cade Mall Shopping Center

KFC: Basement Floor of Cade Mall Shopping Center

A lot of food delivery services are provided by eleme (饿了么), Meituan (美团外卖) or other apps. It is also very easy to order food on your phone and pickup from the South Gate. Lots of restaurant have online order platform on Wechat (微信) as well. McDonald's, KFC, Domino's, Burger King, and Pizza Hut all have food delivery that can be ordered on Wechat.

Transportation

Public Transportation in Beijing

We advise international student to choose public transportation using Beijing municipal administration and communications card (市政公交一卡通, Shizheng Gongjiao Yikatong) when travelling in Beijing. You can buy and recharge the card on every subway station. The card can be used on both subway and bus. Public transportations such as Subway (BJTU is near Xizhimen Station), bus are not only convenient and efficient, but also economical and environmental.



Xizhimen subway station is an important transfer station which is not far from the university. You can transfer to Line 2, Line 13 and Line 4. Subway Line 2 connects Airport Express.

Stops of No. 16, 26, 305 and Yuntong 105 buses are near the south gate of BJTU. (Beijing Jiaotong Daxue bus station)

Stops of No.87, 651, Yuntong 103, 483 buses are near the east gate. (Jiao Da Donglu bus station)

Stops of No. 16, 26, Yuntong 103 buses are near the west gate. (Daliushu Nanzhan bus station)

You can also travel in Beijing by taxi which is very convenient. (the Beijing Subway map is showed on the next page.)

Travel in China

Regarding to travelling in China, railway is the NO.1 choice. There are 4 railway

stations in Beijing (Beijing North Railway Station, Beijing South Railway Station, Beijing Railway Station, and Beijing West Railway Station). Meanwhile, travelling by air or by coach is also available. Beijing has two airports, the Capital International Airport and Nanyuan Airport. There are many railway and flight agent office around the university, and you can also buy tickets online. Purchasing ticket is always an easy thing.

The website address of railway tickets:

<http://www.12306.cn/> (the one and only ticket website)

The website address of flight tickets:

<http://www.ctrip.com/>

<http://www.qunar.com/>

<https://www.alitrip.com/jipiao/>

.....

You can also buy tickets on airlines official website.



北京地铁 BEIJING SUBWAY

图例: Legend

- 地铁一号线
- 地铁八号线
- 地铁二号线
- 地铁四号线
- 地铁五号线
- 地铁六号线
- 地铁七号线
- 地铁八号线
- 地铁九号线
- 地铁十号线
- 地铁十三号线
- 地铁十四号线
- 地铁十五号线
- 地铁房山线
- 地铁昌平线
- 地铁亦庄线
- 机场线

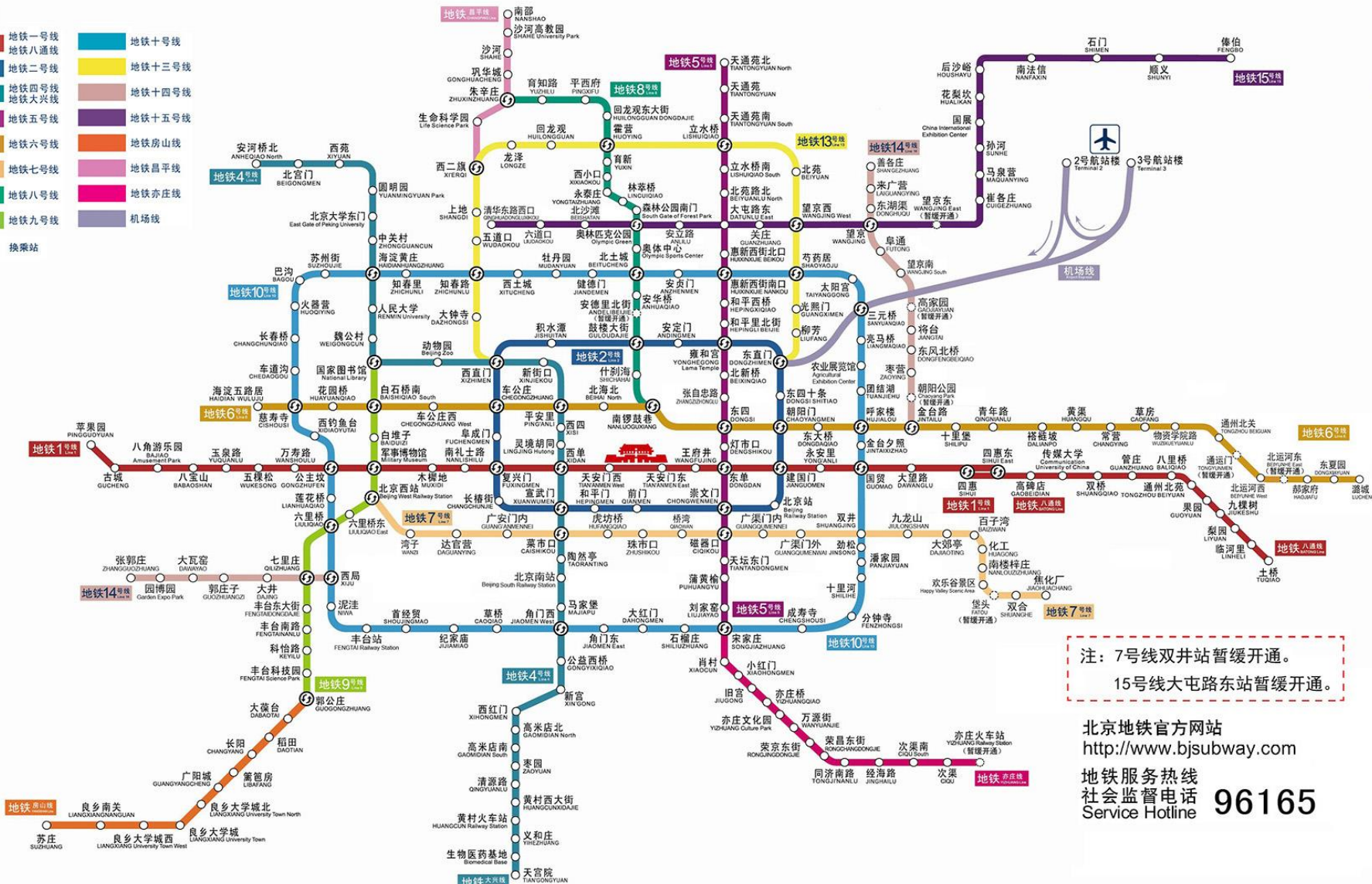

注：7号线双井站暂缓开通。
15号线大屯路东站暂缓开通。

北京地铁官方网站
<http://www.bjsubway.com>

地铁服务热线
社会监督电话 96165
Service Hotline

Communications

Phone

There are only three mobile operators in China, China Mobile, China Unicom, and China Telecom. You can choose which operator to use, service and price between them is not much difference.

The operators will offer different kinds of packages and plans that include talk time, Internet traffic, and SMS services.

There are mobile service outlets of the three operators surrounded the university in walk distance.



中国移动
CHINA MOBILE



中国联通
CHINA UNICOM



中国电信
CHINA TELECOM

Internet

Wi-Fi is full coverage on campus. You can apply an internet account with your Student ID Card in Level 1 of Student Recreation Center (学生活动中心), IT Center Desk. You need to put money first into Student ID Card then register for internet access account. Charges are 20 RMB for one month. If your home university has Eduroam, BJTU is also covered with Eduroam and you may use wifi with it as well. To put money in your Student ID Card, you may go to Service Kiosk during lunch or dinner hour at Canteen No. 1 or 2 with cash.

Mail

There is a China Post Office located near south gate. You can mail items or money through the post office.

Open time

Monday through Friday 9: 00am -12: 00pm; 14: 00pm-17: 00pm

You can also send items by express company; all you need to do is making a phone call.

Facilities

Student Recreation Center

Location: near the west gate

Functions:

- I. Canteens on the 1st, 2nd and 3rd floors including a canteen for Muslims, 3000 seats
- II. One-Stop Service Center for Students on the first floor (E-card Recharge and Internet Payment etc.)
- III. Cafe on the 3rd floor
- IV. Music Hall



Library

Location: near the Lake Ming

Functions:

- I. 1.62 million volumes
- II. Distinctive data base of railway traffic and transportation
- III. 350,000 electronic books
- IV. Well-equipped electronic reading rooms, audio and video rooms

Open time:

Monday, Tuesday, Wednesday and Friday: 8: 00-22: 00

Thursday: 8: 00-12: 00, 18: 30-22: 00

Saturday: 9: 00-17: 30

Sunday: 9: 00-22: 00

Please be noted that library only lend books to degree-seeking students. If you wish to read the book you may read it in the library.



Computer Center

Location: Behind Siyuan Building

Function: Making E-card
School Hospital

Location: near the east gate

Functions: services of general practitioners and emergency treatment



Listening Room

Location: Room 106, No.14 Building

Functions: helping international students to release the emotional crisis, culture shock, study pressure and psychological trauma.



Gym

Location: near the west gate

Function: body shaping, badminton, table-tennis, basketball, volleyball



Ground Track Field

Location: near the west gate

Function: body shaping, badminton, table-tennis, basketball, volleyball

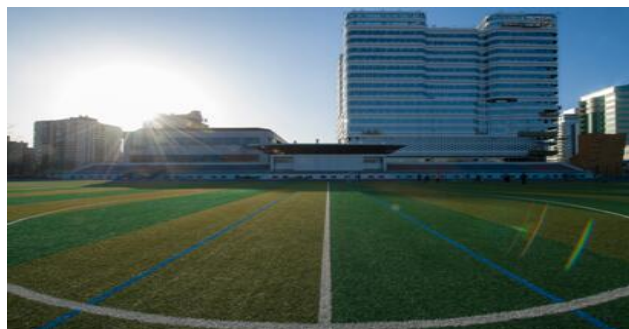

Tianyou Hall

Location: near the Siyuan West Building

Function: conference and exhibition



There is a campus map of BJTU on the next page.



- 超市 Market
- 复印 Copy
- 食堂 Canteen
- 咖啡厅 Cafe
- 小卖部 Buffet
- 留学生公寓 International Student Dormitory
- 校园一卡通自助终端分布 Campus Card Terminal
- 教室 Classroom

ATM	
中国银行 95566; Bank of China (BC)	光大银行 95595; China Everbright Bank (CEB)
交通银行 95559; Bank of Communications (BC)	民生银行 95568; China Minsheng Bank (CMB)
建设银行 95533; Construction Bank of China (CBC)	华夏银行 95577; Huaxia Bank (HB)
工商银行 95588; Industrial and Commercial Bank of China (ICBC)	

联系方式
Tel : +86-10-5168 4535; 51688201; 51688351
Fax : +86-10-6225 5671
Email: apply@bjtu.edu.cn; wscxk@bjtu.edu.cn
Web : http://www.njtu.edu.cn/gjgwsw/

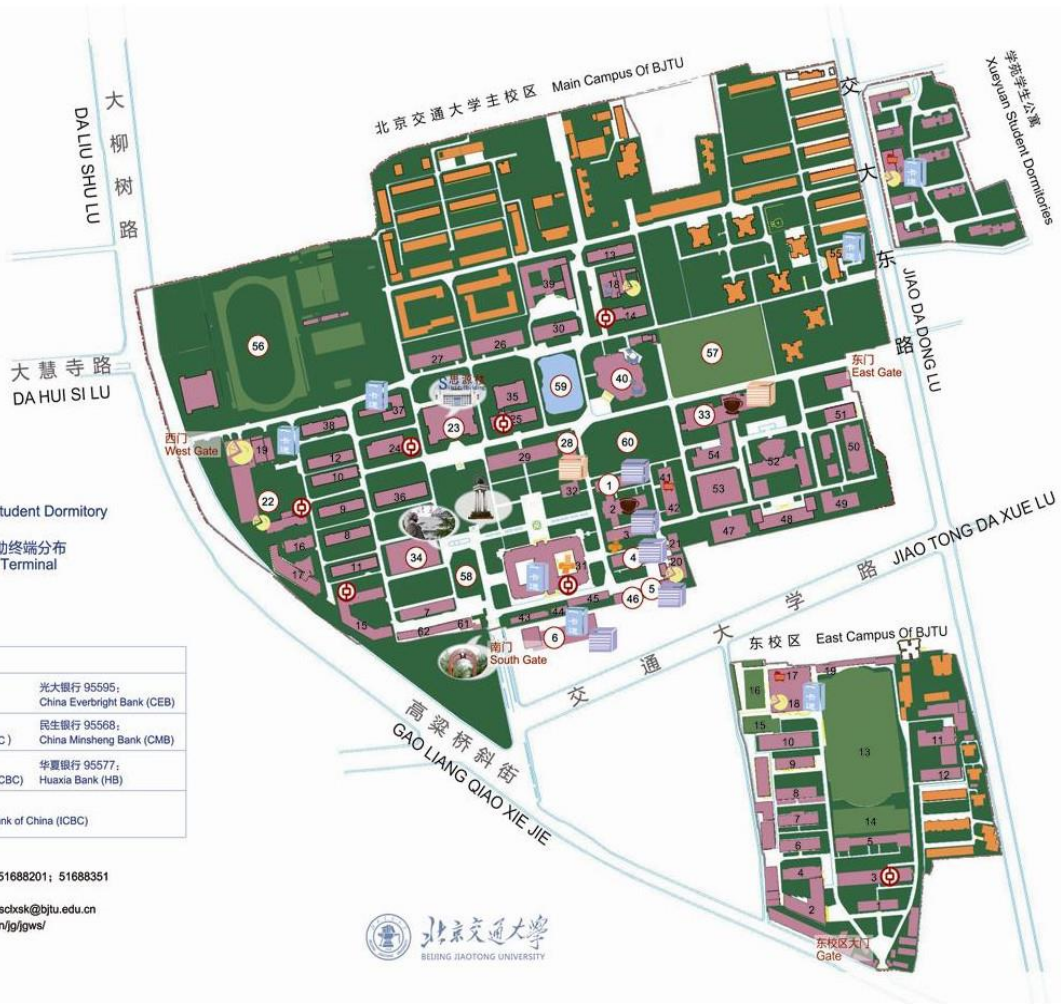

学院及相关部门 Schools & Related Divisions

电子信息工程学院:	School of Electronics and Information Engineering	31
计算机与信息学院:	School of Computer and Information Technology	31
经济管理学院:	School of Economics and Management	25
交通运输学院:	School of Traffic and Transportation	30
土木建筑工程学院:	School of Civil Engineering and Architecture	48
机械与电子控制工程学院:	School of Mechanical, Electronic and Control Engineering	52
电气工程学院:	School of Electrical Engineering	54
理学院:	School of Science	29
人文社会科学学院:	School of Humanities and Social Sciences	24
马克思主义学院:	School of Marxism	24
语言与传播学院:	School of Foreign Languages and Mass Communication	24
软件学院:	School of Software Engineering	33
建筑与艺术学院:	School of Architecture and Art Design	38
国际合作交流处:	Office of International Cooperation & Exchange	46
国际教育交流中心:	Center for International Education	46, 5
国际汉语培训中心:	Chinese Language Training Center for International Students	5
国际汉语培训中心专用教室:	Special Classroom for Chinese Language Training Center for International Students	33, 28
信息中心:	Information Center	22, 37
图书馆:	Library	40

北京交通大学主校区 Main Campus

*1 1号留学生公寓 No.1 International Student Dormitory	*33 逸夫教学楼 Yifu Teaching Building
2 红奥西馆 Hongguoyuan Hotel	*34 天佑会堂 Tianyou Hall
3 3号专家公寓 Expert Hotel	*35 科学会堂 Science Auditorium
*4 4号留学生公寓 No.4 International Student Dormitory	36 档案馆 Archives
*5 14号留学生公寓 No.14 International Student Dormitory	*37 计算机中心 Computer Center
*6 田园学生公寓 A, B, C Tianyuan Student Dormitory	38 建筑艺术系 Department of Architecture and Art Design
7 2号学生宿舍楼 No.2 Student Dormitory	39 运输设备展览馆 Transportation Teaching House
8 7号学生宿舍楼 No.7 Student Dormitory	*40 图书馆 Library
9 8号学生宿舍楼 No.8 Student Dormitory	*41 珠光超市 Zhuangguang Market
10 9号学生宿舍楼 No.9 Student Dormitory	42 学生浴室 Student Bathing House
11 12号学生宿舍楼 No.12 Student Dormitory	43 招生就业处 Admission Office
12 15号学生宿舍楼 No.15 Student Dormitory	44 保卫处 Security Office
13 16号学生宿舍楼 No.16 Student Dormitory	45 印刷厂 Print Workshop
14 18号学生宿舍楼 No.18 Student Dormitory	*46 国际合作交流处 Office of International Cooperation & Exchange
15 19号学生宿舍楼 No.19 Student Dormitory	国际教育交流中心 Center for International Education
16 20号学生宿舍楼 No.20 Student Dormitory	47 工程结构实验室 Lab of Engineering Structures
17 22号学生宿舍楼 No.22 Student Dormitory	48 工程实验中心 Engineering Experiment Building
*18 学生1餐厅 No.1 Canteen	49 隧道中心 Tunnel Center
*19 清真食堂 Islamic Canteen	50 光波楼 Optical Wave Building
*20 学生4餐厅 No.4 Canteen	51 机械工程实验中心 Mechanical Engineering Experiment Center
*21 田园餐厅 Liyuan Canteen	52 机械工程楼 Mechanical Engineering Building
*22 学生活动服务中心 Student Activity and Service Center	53 机械实验馆 Mechanical Experiment House
*23 思源楼 Siyuan Building	54 电气工程楼 Electrical Engineering Building
24 思源西楼 Siyuan West Building	*55 校医院 University Hospital
25 思源东楼 Siyuan East Building	*56 西门体育场 Stadium at West Gate
26 教学楼1 No.1 Teaching Building	*57 东门运动场 Stadium at East Gate
27 教学楼2 No.2 Teaching Building	*58 小树林 Small Woods
*28 教学楼5 No.5 Teaching Building	*59 明湖 Ming Lake
29 教学楼7 No.7 Teaching Building	*60 芳华园 Fanghua Garden
30 教学楼8 No.8 Teaching Building	*61 邮局 Post office
31 教学楼9 No.9 Teaching Building	62 车库 Garage
32 东阶楼 East Amphitheatre	

北京交通大学东校区 East Campus

1 远程与继续教育学院 School of Distance Learning and Continuing Education	10 东5学生宿舍楼 East No.5 Student Dormitory
2 科技大楼 Technology Building	11 图书馆 Library
3 东教1楼 East No.1 Teaching Building	12 培训中心 Training Center
4 东教2楼 East No.2 Teaching Building	13 体育场 Stadium
5 东教3楼 East No.3 Teaching Building	14 篮球场 Basketball Field
6 东1学生宿舍楼 East No.1 Student Dormitory	15 体育馆 Gymnasium
7 东2学生宿舍楼 East No.2 Student Dormitory	16 游泳池 Swimming Pool
8 东3学生宿舍楼 East No.3 Student Dormitory	17 礼堂 Auditorium
9 东4学生宿舍楼 East No.4 Student Dormitory	18 食堂 Canteen
	19 医务室 Infirmary

留学生公寓 Xueyuan Student Dormitories

Student association

BJTU has specific societies for international students, such as the International Student Union of Beijing Jiaotong University, African Union of Beijing Jiaotong University, basketball team, football team, photography society, etc., which played an constructive role in students' extracurricular living, cultural exchange and study.

Furthermore, BJTU have more than 100 student societies in the 6 fields including scientific research, sports, culture and arts, public service and so on. To name a few, the Science and Technology Association, Volunteer Service Association and the Art Society. Among them, the Rainbow Chinese and Foreign Exchange Society is the bridge for the Chinese and foreign students friendship. Welcome to join the students associations of BJTU!



Basketball Team



Football Team



African Union



Symphony Orchestra

Window to Africa by

Other information

Medical Care

BJTU has an on-campus clinic providing health care services to members of the university. Our aim is to help you maintain good health - physical and psychological - so that you can perform to the best of your ability. We provide a wide range of health education programs, exhibitions, and classes to promote and maintain the health of the individual and the community.

We provide a choice of highly qualified and experienced doctors from various backgrounds who provide a high standard of reliable primary care with a high degree of continuity.

Time:

Monday - Friday 8:30 am - 5:30 pm

Saturday 8:45 am - 12:25 pm

Walk-ins accepted

Charges:

Primary care consultations are generally provided 90% discount of charge to those who are eligible - see Medical Benefits for Students or Staff for details. Students only pay 10% of the cost. There are charges for non-eligible visitors, insurance and other reports, certain procedures, medications and sundry items.

Hospital off campus

Peking University People's Hospital is the nearest Class 3 Grade 1 Hospital around BJTU. The address is No.1 Building, 11# Xizhimennandajie, Xicheng District. This famous polyclinic was founded in 1918, and there are 18 key clinical specialities of MOH.

Shopping Mall

Cade Mall, which is well-known as a comprehensive shopping mall for its shopping, catering and leisure service, is only around 1 kilometer from BJTU. The address is: 1# Xizhimenwaidajie, Xicheng District. People can buy clothes from NIKE, ADDIDAS, UNIQLO, GAP, VERO MODA and PEACEBIRD etc in here, and they can also enjoy brilliant food provided by Wangxiangyuan, Nanjingdapaidang, Malayouhuo and Xiti Steak etc. What's more, people can relax at Jingcheng Archery Club.

You can also go further to Xidan commercial area or Zhongguancun business district for more shopping malls and brands.



Supermarkets

There are three big supermarkets near campus where you can buy almost everything you need in your daily life.

Lotte Mart: 2 Sidaokou Road, Haidian District. (In walk distance from campus)

BHG Market Place: B1 Cade MALL Shopping Center, 1 Xizhimenwai Street, Xicheng District. (The same location as Xizhimen subway station)

Take bus 16, 26, Yuntong105 to Chengtie Xizhimen Stop.

Carrefour: Fangyuan Hall, 54 Baishiqiao Road, Haidian District.

Take bus Yuntong 105 from Beijing Jiaotong University Stop to Baishiqiao East Stop.

Sightseeing in Beijing

Tiananmen and Tiananmen Square

Located in the center of Beijing, Tiananmen Square is the largest square in the world. It covers 44 hectares and can hold one million people. On October 1, 1949, the square was where the People's Republic of China was inaugurated.



The Forbidden City

The Forbidden City is China's most imposing architectural masterpiece. It represents many aspects of China's long history and is the largest museum of oriental art in the world. Located in the center of Beijing, the Forbidden City was built between 1406 and 1420. Twenty-four emperors of the Ming and Qing Dynasties once lived there. The entire palace covers an area of 72 hectares and boasts over 9,000 rooms and halls. Walking through the palace, visitors will have the feeling of passing through a historical corridor.



The Great Wall

China's Great Wall is the only man-made object visible from satellites and is one of man's most remarkable accomplishments. Construction of the Great Wall began in the 7th century B.C. This magnificent wonder starts at Shanhai Pass in the east and ends at Jiayu Pass in the west, stretching more than 6,000 kilometers.



The Ming Tombs

The Ming Tombs are the burial ground of thirteen Ming Dynasty emperors. Of these thirteen tombs, only two, Dingling and Changling, are open to public. Changling, the largest and the oldest of the thirteen, is Emperor Zhu Di's tomb. Dingling is the tomb of Emperor Zhu Yijun, and is the only one to be excavated so far.

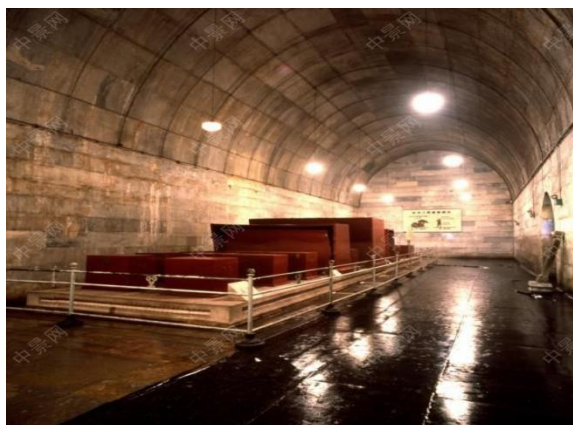

The Temple of Heaven

Located in the southeast of Beijing, the Temple of Heaven was built in 1420. Ming and Qing emperors went there to worship heaven and pray for good harvests. Different from the Forbidden City with yellow tiles and red walls, this temple adopts blue as its major color, suggesting the sky.

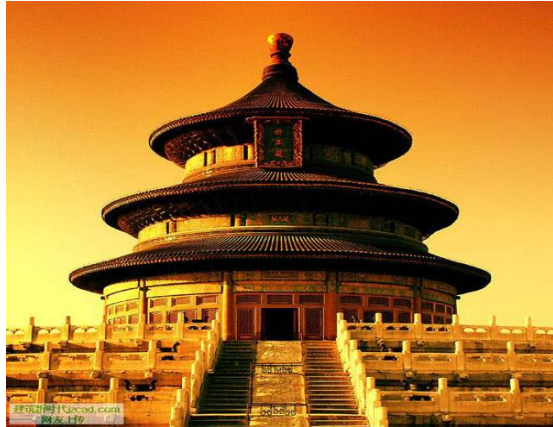

The Summer Palace

Summer Palace, the largest garden and twenty kilometers northwest of Beijing, has a history of over eight hundred years. It was the place where the imperial families of the Qing Dynasty handled government affairs, spent summer time, celebrated birthdays and simply came for relaxation.

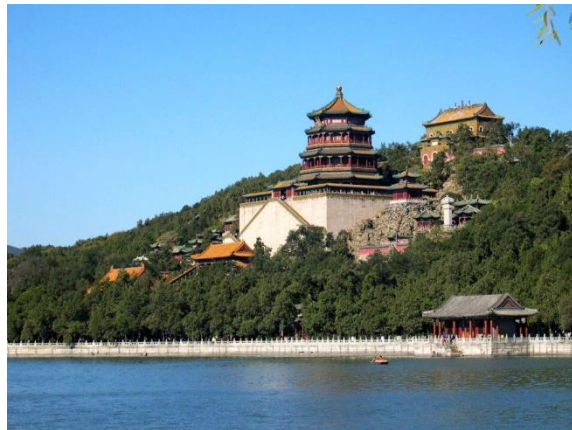

Beijing Capital Museum



If you are sightseeing in Beijing, do remember to include the Beijing Capital Museum in your itinerary. Among the major tourist attractions in Beijing, this museum is located on the Guozijian Street. Speaking of its history, the plan to set up the Beijing Capital Museum was drafted in 1953, but it was only in 1981 when the museum was formally declared open to the world. Speaking of the Beijing Confucius Temple in which the Beijing Capital Museum is housed, it was built in 1302 AD, which happened to be the sixth year of the Dade reign period of the Yuan dynasty. The second largest temple in China, the Beijing Confucius Temple occupies an area of 22000 square meters and has three wide courtyards. The Xianshi Gate of the temple now serves as the entrance to the Beijing Capital Museum. The Beijing Capital Museum in Beijing houses a fine collection of cultural relics that can be classified into 21 broad categories. They include glassware, stone inscriptions, paintings, bronze/silver/bronze wares and a variety of silk fabrics. However, the most ubiquitous of all items are good quality porcelain wares designed in the most fascinating manner. Entry tickets to the Beijing Capital Museum cost RMB 10 yuan each and the

museum remains open from 8:30am to 16:30pm every day except Monday.

798 Art Zone

798 Art Zone or Dashanzi Art District, is a part of Dashanzi in the Chaoyang District of Beijing that houses a thriving artist community, among 50-year old decommissioned military factory buildings of unique architectural style. It is often compared with New York's Greenwich Village or SoHo. The area is often called the 798 Art District or Factory 798 although technically, Factory #798 is only one of several structures within a complex formerly known as Joint Factory 718. The buildings are located inside alleys No. 2 and 4 on Jiuxianqiao Road, south of the Dashanzi flyover.



National Centre for the Performing Art

National Centre for the Performing Arts is a dynamic new icon to the arts in the heart of old Beijing. The Centre's ultra-modern architecture is in sharp contrast to its neighbours, the Great Hall of the People, Tiananmen Square and the ancient Forbidden City. The National Centre for the Performing Arts is far more than a spectacular and futuristic building. It is China's new face on the performing arts. It is a stage for the



world's greatest artists. It will showcase China's burgeoning international stars and celebrate the creativity of its many ethnic cultures. Its location at No. 2 West Chang'an Avenue and its masterful, creative design are testament to the prestige China has placed on the performing arts. The Centre hosted its first official concert on December 22, 2007,

signaling a coming of age for performance art in China. Three main performance venues, along with a host of resource facilities, are cunningly housed under the Centre's ellipsoid shell.

Wangfujing

The 700-year-old Wangfujing Street is not the most interesting street in Beijing but it is probably the most famous and busiest. Because of its easy access to the major roads, high land prices, high density of retail and service business and the high degree of population flow, Wangfujing is now considered the city's central business district. What attracts, is the Xinhua Bookstore and the Beijing Foreign Languages Bookstore, nice places to spend all day, reading, reading and reading. As to eating in Wangfujing, the "Goubuli" restaurant sells some of the best steamed buns in town. Another thing about



Wangfujing is that you can freely walk around because much of the road is off-limits to cars and other motor vehicles. Wangfujing is located in the Dongcheng District of Beijing. The street has an extension of 1,150 meters, from Wangfujing Nankou to Dengshi Xikou. Wangfujing is served by Line 1 of the Beijing subway (at the southern end of the street). Line 1 is an important subway line for you because is the only one that runs

through the centre of Beijing (it runs from Pingguoyuan (west) to Sihui East (East), through beneath the extended Chang'an Avenue and the commercial areas of Xidan, Wangfujing and Dongdan. It also has two stations in both sides of Tiananmen.

Bird Nest

Located at the southern part of the Olympic Green in Beijing, the National Stadium is the main stadium of the 29th Olympiad in 2008. Occupying an area of 21 hectares, it has a floor space of 258,000 square meters. Its seating capacity amounts to 91,000, including 11,000 temporary seats.

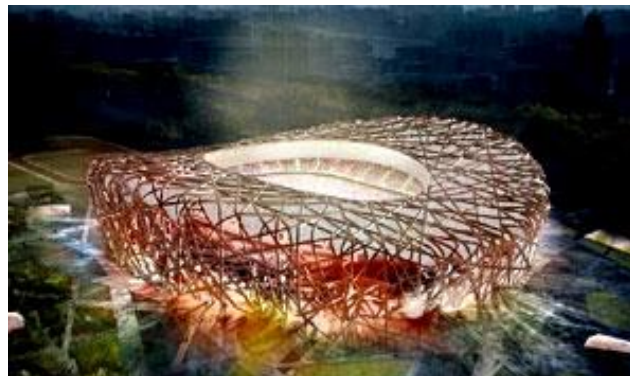

The venue hosted the opening and closing ceremonies of the Beijing Olympic Games and Paralympic Games, the track and field competitions, and the football finals. After the Olympics, the stadium became a large-scale sports and entertainment facility for the residents of Beijing -- an architectural landmark and Olympic legacy.

Water Cube

The National Aquatics Center is the only landmark Olympic stadium sponsored by countrymen and overseas Chinese in Hong Kong, Macao and Taiwan under the direction of the Beijing Municipal Government. With the theme of "New Beijing, New Olympics" and the concept of a "people's Olympics," it expresses the Chinese people's good wishes for the 2008 Beijing Olympics and demonstrates the spirit of national unity in contributing to the Games. The National Aquatics Center is located in the south-central part of the Beijing Olympic Park near the middle axis of the city, with the National Stadium on the opposite side of the axis. The Games-time facility is nearly to 80,000 square meters in area, containing 17,000 standard seats, including 6,000 permanent seats and 11,000 temporary seats. After the Games, the National Aquatics Center has been transformed into a multi-function international center combining sports training, cultural entertainment and physical fitness.

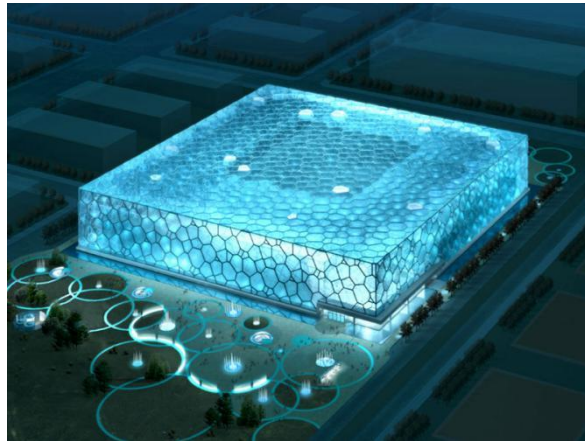

South Luogu Alley (The famous hutong in Beijing)

South Luogu Alley, located between Beijing Gulou and Di'anmen, can be traced back to the Dadu period of Yuan Dynasty, and has a history of nearly 800



years so far. The streets and lanes, about 786 meters long, run through the north and the south, with perfectly preserved 16 symmetrical Hutong patterns of Yuan Dynasty on two sides. Starting from 2002, many bars appeared on the antique and quiet lane. In around 2003, bars and other small stores of South Luogu Lane increased to 70-80, and became another bar street following Sanlitun and Shichahai.

These bars and unique stores, simply decorated on the basis of the original quadrangles, basically keep the original pattern and feature of Beijing Hutong in spite of a variety of fashion factors. Tourists from around the world stop at the deep and serene South Luogu Lane; young people in the city also like to come here by themselves or chat with their friends here. The simple and modern South Luogu Lane feels the breath of the city in development, and is brimming with more charm as time goes by.

Shichahai Lake

Surrounded by Shichahai Lake and Beijing Hutong, Houhai bar street is a hot scenic spot receiving thousands of locals and worldwide visitors, such as courtiers, poets and painters. No matter it is walking beside Houhai lake, shopping in Yandaixiejie, riding in Hutong, or drinking in the stylistic bars and dining in a lake-side restaurant, the time in this street can be very exciting and entertaining.



There are many different bars and restaurants that lined the shores of the manmade lake.

Sanlitun Bar Street

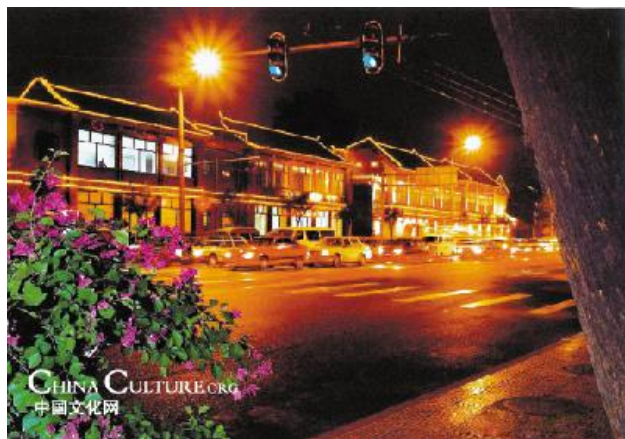

Sanlitun Bar Street, a tree-lined neighborhood of foreign diplomatic compounds, is located in the Chaoyang District, northwest of the city center between the Workers Stadium (Gongrentiyuchang) and the North Third Ring Road.

There are also plenty of nightlife venues opening along the adjacent Gongrentiyuchang Street all the way east to Chaoyang Park. Most of

these small, privately owned cafe/bars serve western cuisine by day and imported beer, wine, and spirits by night. They attract a large number of foreign residents, diplomats, students, as well as young, moneyed Beijingers. In summer, most of these cafe/bars offer outdoor seating in the sunlit hours. Sanlitun Bar Street is the liveliest and most compact nightlife district in Beijing. Most of the bars and cafes are situated chockablock on the east side of Sanlitun Road running north from the intersection at Gongrentiyuchang North Road (west of the East Third Ring Road). Here a green sign announces (in English) that you are at the gateway to Sanlitun Bar Street. The sidewalk is strung with bright pennants and table umbrellas. The cafes, bars, and clubs line the street and alleyways for the next 4 blocks, but the farther north you walk, the more likely it is that the bars will be interspersed with small boutiques, art galleries and rattan furniture shops. Eventually you reach the north end of Sanlitun Road, where the foreign embassies and consulates are located, but there are cafes and bars here, too. Along the southern shore of the Liangma River, one block west off Sanlitun Road, is Schillers II, a bar and restaurant long popular with foreigners in Beijing and open daily from 5pm to 1am. If you follow the river east, you'll come to the Third Ring Road area, the location of Beijing's own Hard Rock Cafe.

Emergency Telephone Numbers

Police 110

Fire 119

Emergency Center 120